

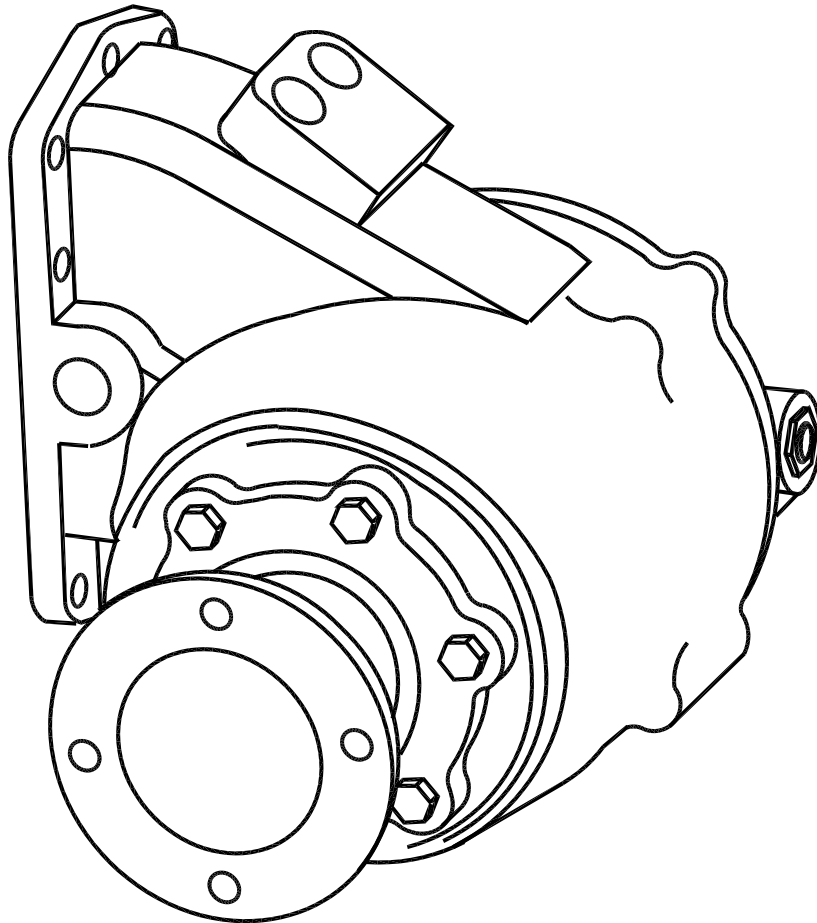

CS14 SERIES CLUTCH SHIFT PTO

PARTS LIST



U.S. Patent 5,542,306

FOR THE ALLISON WORLD TRANSMISSION

Muncie Power Products, Inc. General Offices and Distribution Center • P.O. Box 548 Muncie, IN 47308-0548
(765) 284-7721 • FAX (765) 284-6991 • E-mail info@munciepower.com Web site <http://www.munciepower.com>
Drive Products, Inc. Toronto, Exclusive Agents for Canada



Muncie[®]
Power
Products

CS14 SERIES CLUTCH SHIFT PTO EXPLODED VIEW

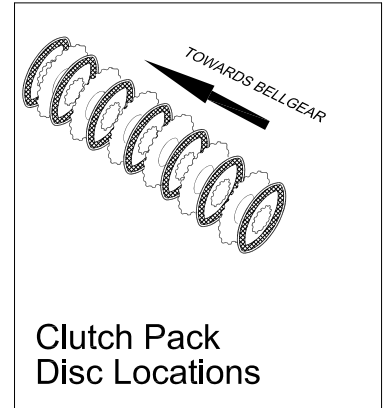

See Cover
Detail

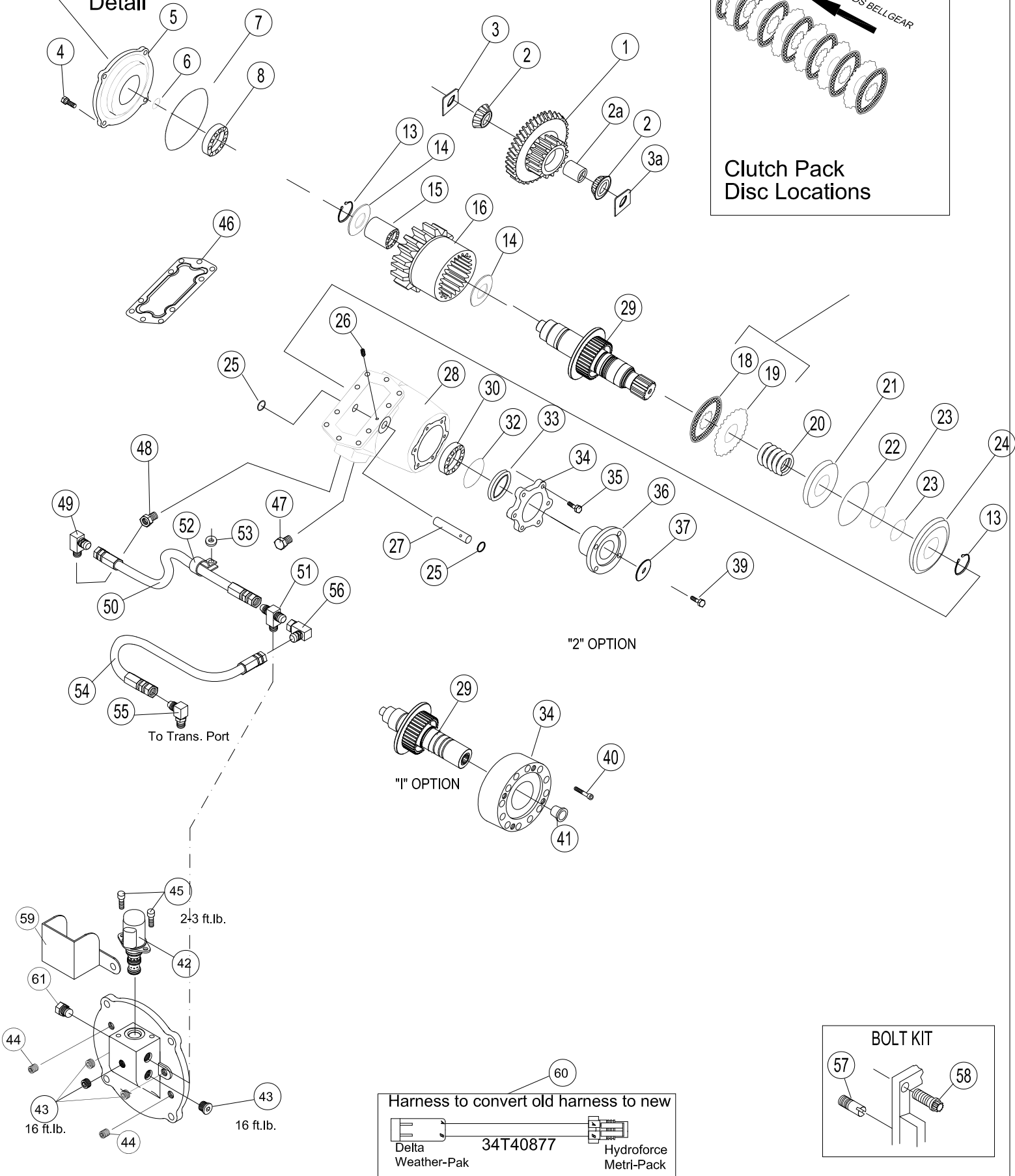

"2" OPTION

"1" OPTION

To Trans. Port

2-3 ft.lb.

16 ft.lb.

16 ft.lb.

Harness to convert old harness to new

Delta Weather-Pak 34T40877 Hydroforce Metri-Pack

BOLT KIT

57 58

CS14 PARTS LIST AND DESCRIPTION

ITEM	QTY	PART NO.	DESCRIPTION	ITEM	QTY	PART NO.	DESCRIPTION
1	1	03T36214	Input Gear (05) (50/27)	30	1	10T35775	Output Bearing
		03T36215	Input Gear (06) (50/29)	32	1	12T35773	O Ring
		03T36216	Input Gear (07) (50/31)	33	1	11T37795	Seal
		03T36217	Input Gear (08) (50/34)	34	1	15T39226	Bearing Cover, Open "2"
		03T36218	Input Gear (10) (50/36)			14T36834	Hyd Flange "I"
2	2	10T35776	Input Bearing	35	6	19T32740	Capscrew "2"
2a	1		below as required	36	1	14T37498	DIN Companion Flange "2"
		18T38748	Cone Spacer	37	1	21T20092	Washer ("2" Only)
		18T38532	Cone Spacer	39	1	19T38266	Capscrew ("2" Only)
		18T38533	Cone Spacer	40	6	19T35386	Socket Capscrew "I" Hyd
		18T38534	Cone Spacer	41	1	25T37767	Cap Plug "I" (Storage Only)
		18T38535	Cone Spacer	42	1	35T40864	Solenoid (24v) (Drop-in)
		18T38536	Cone Spacer	43	4	25T21684	Pipe Plug
		18T38537	Cone Spacer	44	2	19T36174	Set Screw
		18T38538	Cone Spacer	45	2	19T40859	Capscrew
		18T38539	Cone Spacer	46	1	13T35777	Gasket
		18T38540	Cone Spacer	47	1	25T35999	Plug
		18T38590	Cone Spacer	48	1	25T35784	Orifice
		18T38591	Cone Spacer	49	1	43T35867	Elbow
		18T38592	Cone Spacer	50	1	45T35865	Hose
3	1		below as required	51	1	43T36231	Tee
		18T38532	Thrust Washer	52	1	49T36283	Hose Clamp
		18T38533	Thrust Washer	53	1	21T36448	Washer
		18T38534	Thrust Washer	59	1	49T41288	Protector
		18T38535	Thrust Washer	61	1	25T41463	Plug
		18T38536	Thrust Washer	N.S.	1	48TK5164	Installation Kit
		18T38537	Thrust Washer				Includes:
		18T38538	Thrust Washer				Gasket Pack 52MK1010, Stud Kit 20TK4618,
		18T38539	Thrust Washer				Std. Hose Kit 43TK3881
		18T38540	Thrust Washer	60	1	34T40877	Conversion Harness to Drop-in type
		18T38590	Thrust Washer				Included in 48TK kit.
		18T38591	Thrust Washer	N.S.	1	48TK5165	Installation Kit "B" Feature
		18T38592	Thrust Washer				Includes:
		18T38748	Thrust Washer				Gasket Pack 52MK1010, Stud Kit 20TK4618,
3a	1	18T41451	Thrust Washer				Std. Hose Kit 43TK3885
4	4	19T39418	Capscrew				
5	1	15T40861	Bearing Cover, Closed				
6	1	12T36081	O Ring				
7	1	12T36207	O Ring				
8	1	10T35994	Bearing				
13	2	24T39926	Snap Ring				
14	2	10T35989	Thrust Race				
15	1	10T35991	Bearing				
16	1	02T36219	Bell Gear (05) (47T)				
		02T36220	Bell Gear (06) (45T)				
		02T36221	Bell Gear (07) (43T)				
		02T36222	Bell Gear (08) (40T)				
		02T36223	Bell Gear (10) (38T)				
18	7	49T38231	Friction Disc				
19	6	49T38230	Spacer Disc (4/99)				
20	1	27T36112	Spring				
21	1	49T36114	Piston				
22	1	12T36054	O Ring				
23	2	12T36053	O Ring				
24	1	49T40988	Piston Cup				
25	2	12T35774	O Ring				
26	1	19T35785	Set Screw				
27	1	07T35780	Idler Shaft				
28	1	01T42194	Housing (1 Arrangement)				
		01T42195	Housing (3 Arrangement)				
29	1	06TA5227	Output Shaft "2" (Includes Pressed on Clutch Hub Assembly)				
		06TA5226	Output Shaft "I" 36mm 8 SPL				